

# Mind the Bulb: Care tips for your pH sensor

The glass bulbs on pH sensors can be fragile! Follow these tips to prevent breakage and extend your sensor's lifespan.

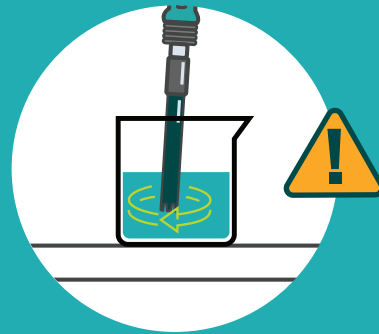

**Avoid hitting the edge of containers**



**Don't use the sensor to stir**



**Beware the stirring bar**

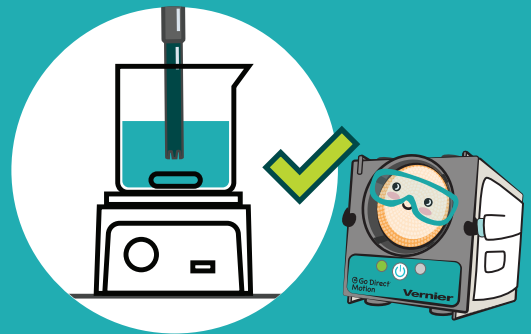

**Only let the glass bulb touch liquid**

**Get more tips on pH sensor care!**

